

**SPECTRUM**  
AQUATICS<sup>®</sup>  
A PLAYCORE Company

**KERSPLASH<sup>®</sup>  
CHALLENGER  
POOL  
CLIMBING  
WALLS**



**READY, SET, CLIMB!**

# KERSPLASH® CHALLENGER POOL CLIMBING WALL

## Features:

- Perfect for retrofit and new construction
- 8-, 12-, or 16-foot climbing height
- Ships flat, saving time and money
- Robust modular, scalable design
- Easy installation
- Custom logos and powder-coating options
- Frame is constructed of 100% USA-Made stainless steel

KERSPLASH® Challenger Pool Climbing walls add sleek design elements and fun for all ages in both indoor and outdoor applications. Available in clear, blue, and green translucent panels.

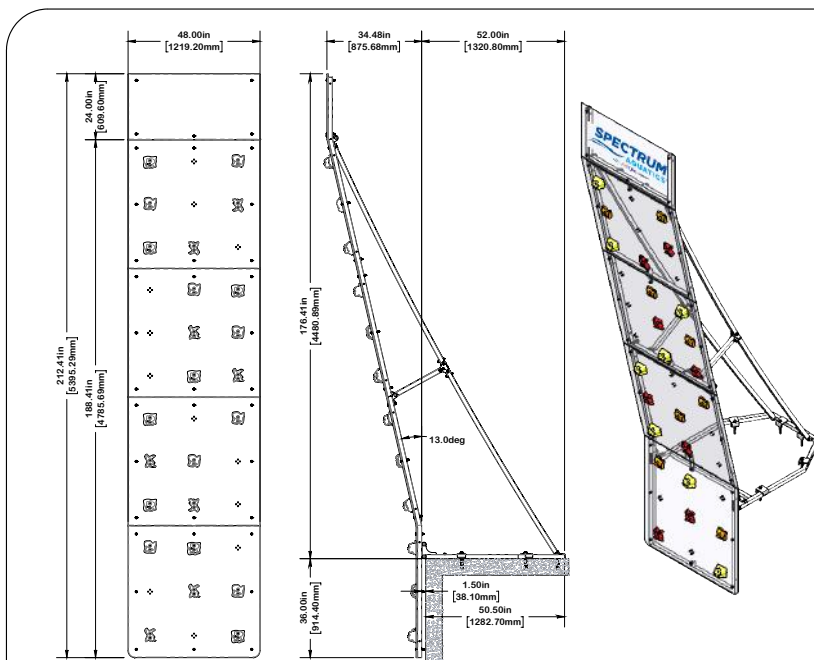

## KERSPLASH™ CHALLENGER 4 PANEL CLIMBING WALL CATALOG#: 2210777

THE KERSPLASH™ CHALLENGER POOLSIDE CLIMBING WALL WILL CONSIST OF THE FOLLOWING COMPONENTS:

**SUPERSTRUCTURE:**  
THE STRUCTURE SHALL CONSIST OF A 16' TALL FRAME. THE FRAME WILL INCLUDE AN 16' TALL SECTION FOR CLIMBING WITH THE UPPER 3 CLIMBING SECTIONS ANGLED 13 DEGREES. THE TOP 2' NON-CLIMBABLE SECTION OF THE CLIMBING WALL SHALL BE VERTICAL. THE SUPERSTRUCTURE OF THE WALL SHALL BE CONSTRUCTED EXCLUSIVELY FROM 304L (LOW CARBON CONTENT) 1.50" SQUARE TUBING STAINLESS STEEL WITH .120", .085", AND .065" WALL THICKNESS. THE STRUCTURE SHALL BE MODULAR ALLOWING FOR ECONOMICAL SHIPPING AND ON-SITE ASSEMBLY. THE STAINLESS WELDMENTS SHALL BE POWDER COATED WHITE TO WITHSTAND THE AQUATIC ENVIRONMENT.

**PANELS:**  
CRYSTAL CLEAR PANELS SHALL BE FABRICATED OF OUTDOOR RATED, DOUBLE SIDE UV PROTECTED, POLYCARBONATE FOR SUPERIOR STRENGTH AND IMPACT RESISTANCE. PANELS SHALL HAVE 8 HOLES ON THE PERIMETER FOR MOUNTING THE FRAME AND 9 SETS OF HOLES TO ALLOW FOR HANDHOLD MOUNTING. PANELS SHALL BE 4' BY 4' DIMENSIONALLY AND ALL SHARP EDGES MECHANICALLY ROUNDED. THE TOP 2' PANEL SHALL HAVE NO HAND HOLDS OR GRASPABLE SURFACE FEATURES TO DETER CLIMBING ABOVE THE DESIGNATED CLIMBING PANELS. ALL PANELS SHALL BE CAPABLE OF WITHSTANDING THE AQUATIC ENVIRONMENT.

**HOLDS:**  
EACH CLIMBING PANEL SHALL COME WITH 6 HAND HOLDS. HAND HOLDS SHALL BE FABRICATED FROM A PROPRIETARY HYBRID RESIN WITH A FORMULATED UV-INHIBITED BLEND SPECIFICALLY ENGINEERED FOR THE AQUATIC ENVIRONMENT. HAND HOLDS SHALL BE ORANGE, YELLOW, AND RED.

**ANCHORS:**  
THE ANCHORS SHALL BE ENGINEERED TO WITHSTAND 105 MPH WIND LOAD WITH A SAFETY FACTOR. AND ANY FORCES INDUCED BY CLIMBING. THE ANCHORING SYSTEM SHALL CONSIST OF QTY. 6 REINFORCED 304L COLD FORMED STAINLESS STEEL BRACKETS THAT CLAMP THE CLIMBING FRAME WITH 1/8" STAINLESS STEEL 1/2"-13 HEX BOLTS. HEX BOLTS SHALL BE INSTALLED INTO EPOXY SET FEMALE THREADED ANCHORS SET PER THE MANUFACTURER INSTRUCTIONS

**FASTENERS:**  
ALL FASTENERS SHALL BE 18-8 S.S. AND CONNECTION POINTS OTHER THAN HAND HOLDS SHALL HAVE LOCK WASHERS OR NYLOC LOCKING ELEMENT NUTS.

**FOOTING REQUIREMENTS:**  
THE FOOTING REQUIREMENTS SHALL BE BASED ON A 105 MPH WIND LOAD, STANDARD 6" THICK POOL DECK SHALL BE SUFFICIENT.

**POOL AND DECK REQUIREMENTS:**  
9 FOOT RECOMMENDED DEPTH. 51" x 48" DECK FOOTPRINT. 4 FOOT CLEARANCE BEHIND THE WALL FOR WALKWAY. 5 FEET CLEARANCE ON EITHER SIDE OF THE WALL. 10 FOOT DROP ZONE. PLEASE CHECK STATE AND LOCAL CODE TO INSURE COMPLIANCE.

**WARRANTY:**  
SPECTRUM STANDARD

**NOTE:**

*△ DIMENSIONS VARY WITH SPECIFIC APPLICATIONS. SPECIFICATIONS ARE NOMINAL AND ARE SUBJECT TO CHANGE. PLEASE CONTACT SPECTRUM AQUATICS FOR CUSTOM APPLICATIONS*

<p>A PLAYCORE Company</p> <p>7100 Spectrum Lane Missoula, Montana 59808 800.791.8056 www.spectrumaquatics.com</p>	<b>ENGINEERING DATA</b>			
	PRODUCT: KERSPLASH CHALLENGER TALL -			
	MODEL #:	2210777	CATALOG #:	2210777
	MATERIAL:	1.50" 304L SERIES STAINLESS SQUARE TUBE		REVISION: A
	FINISH #:	WHITE POWDER COAT		